A woman with blonde hair, wearing a dark blue long-sleeved shirt, is pointing her right index finger towards a computer monitor. The monitor displays a 3D model of a mechanical part. In the background, another person's face is partially visible, looking towards the same monitor. The scene is set in a workshop or office environment with multiple computer monitors and various tools on a desk.

3D-vallankumouksen suunnittelu

12.03.2019
Johannes Karjalainen

 Etteplan

Who am I?

- Johannes Karjalainen
- AM Specialist
- Working in Etteplan since September 2016
- M.Sc. in mechanical engineering
 - Product development
 - Production technology
 - Hydraulics



Etteplan

– a growth company

Rapidly growing and developing engineering services company

Our customers are global machine and equipment manufacturers

We stand out by the high-level competence and service attitude

Founded 1983 | Nasdaq Helsinki Ltd



~215

REVENUE, EUR MILLION 2017

> 3,000

NUMBER OF PERSONNEL

Revenue by geographical area 2017 (2016)



Revenue by service area 2017 (2016)

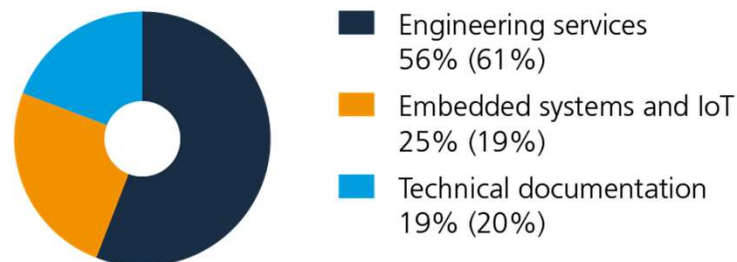

Revenue by customer segment 2017



CORE FACTS

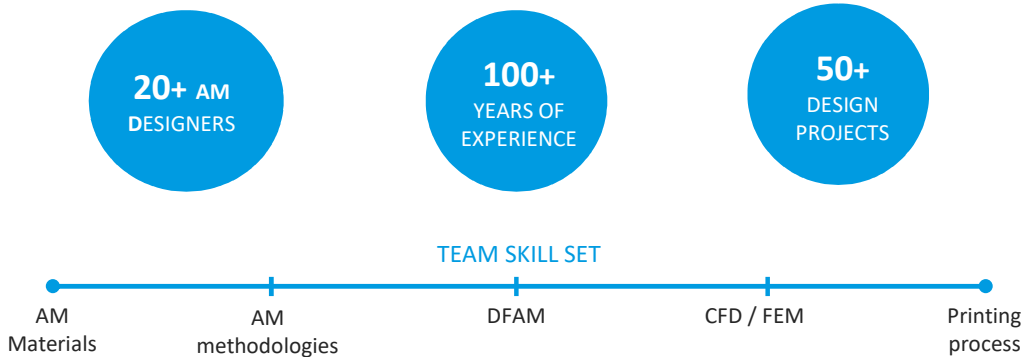

HOW WE WORK

” *We believe in making ideas concrete very early, delivering cost estimations to support decisions making and working closely with our customers to ensure AM feasibility.*

STRONG DOMAINS

- Traditional industry
- Simulation driven AM design
- AM Business case creation
- Commerce & strong partner network

And many more...

WHAT WE DO



THE FUTURE OF ADDITIVE MANUFACTURING





ADDITIVE MANUFACTURING NOW

Manufacturing cost development

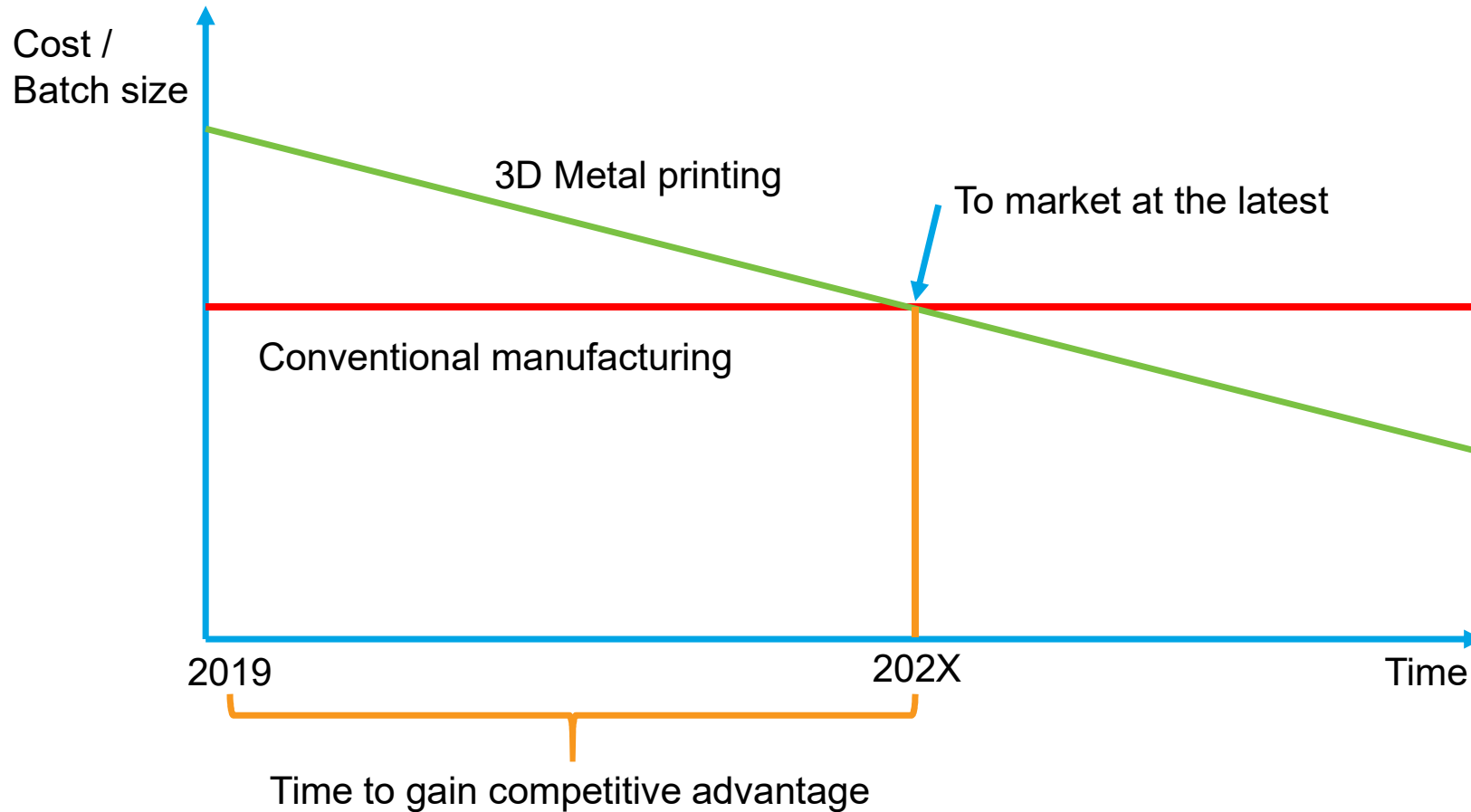

Manufacturing cost development

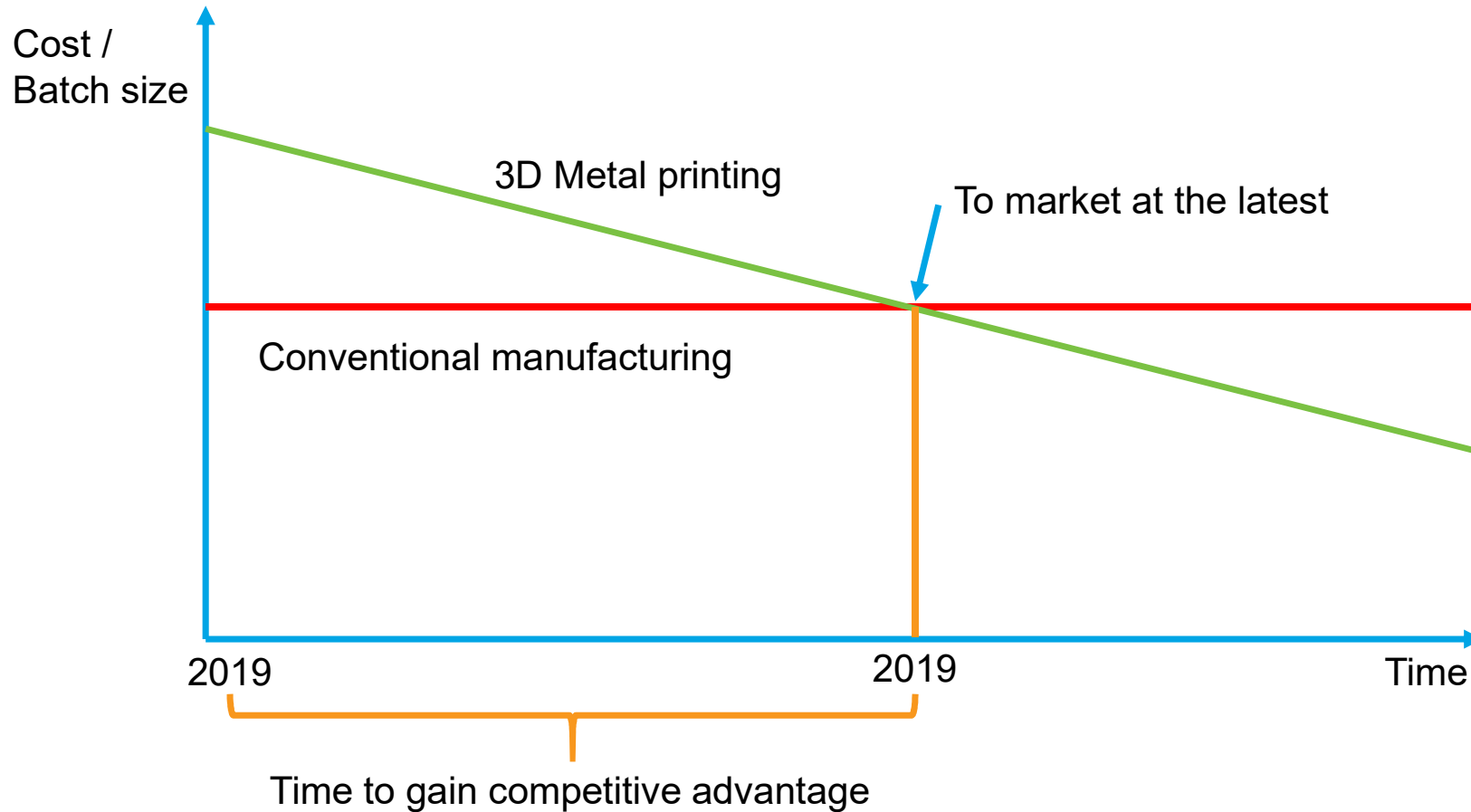

PLANNING 3D REVOLUTION

Steps to AM success

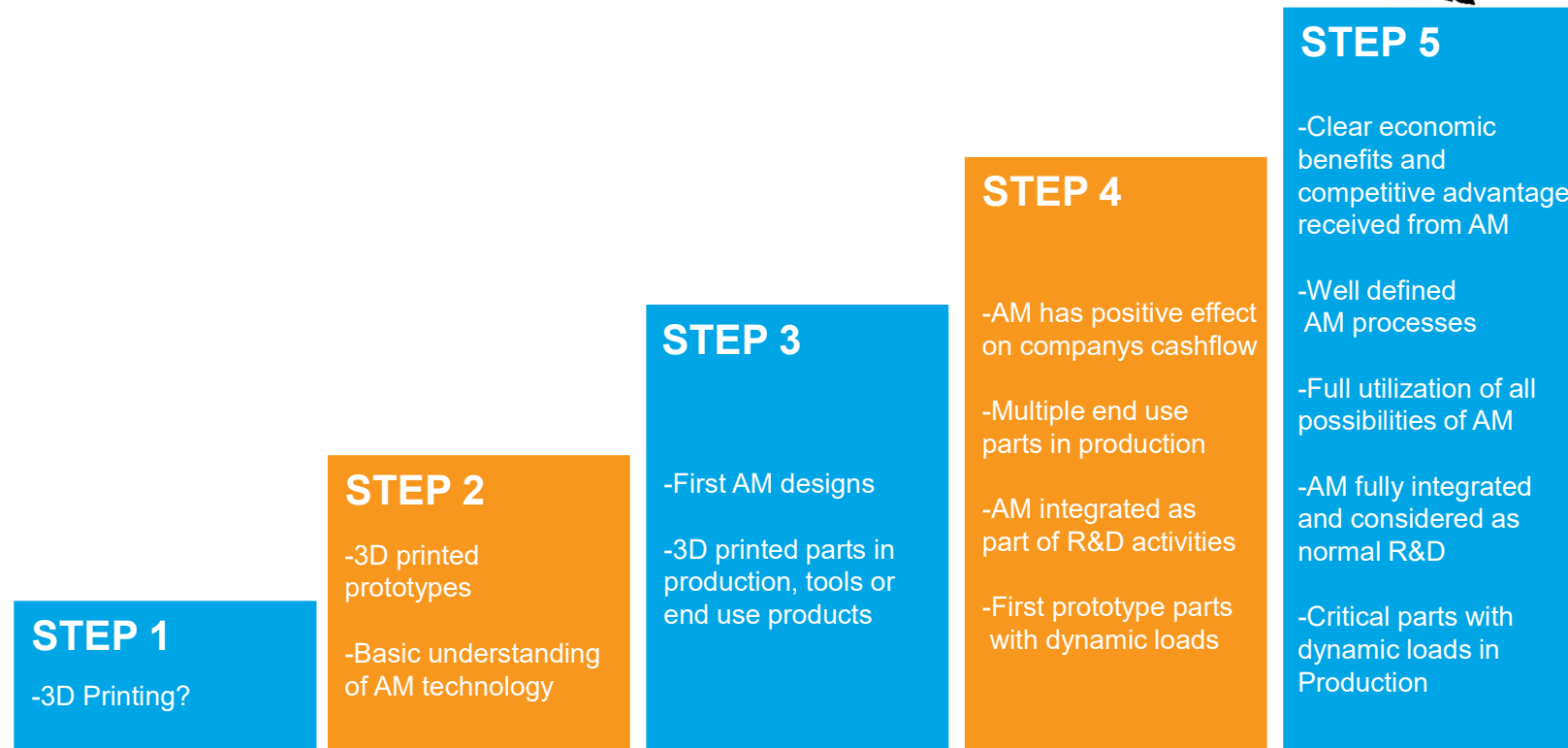

Additive Manufacturing partner



AM ENGINEERING
AfAM / DfAM



TOPOLOGY
OPTIMIZATION

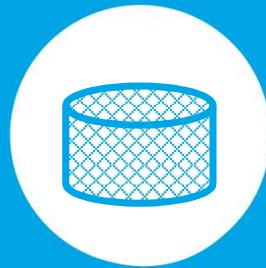

FEM



CFD

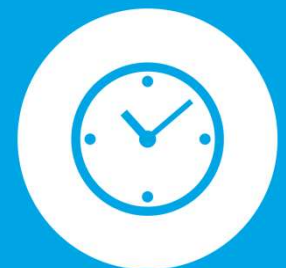

PRINT PROCESS
SIMULATION



AM SCREENING
/ DFMA



NEW PRODUCT DEVELOPMENT
/ CONCEPTING



AM FACTORY
CONSULTANCY

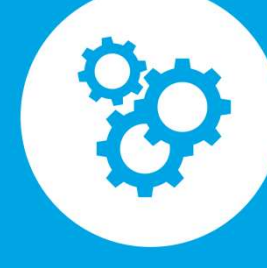

AM TRAINING



AM PURCHASING
SUPPORT

**Most of our references are
confidential, but here are some
that we can share...**

Sandvik AM pilot case



AMO-team



Geneva drive rotator piece

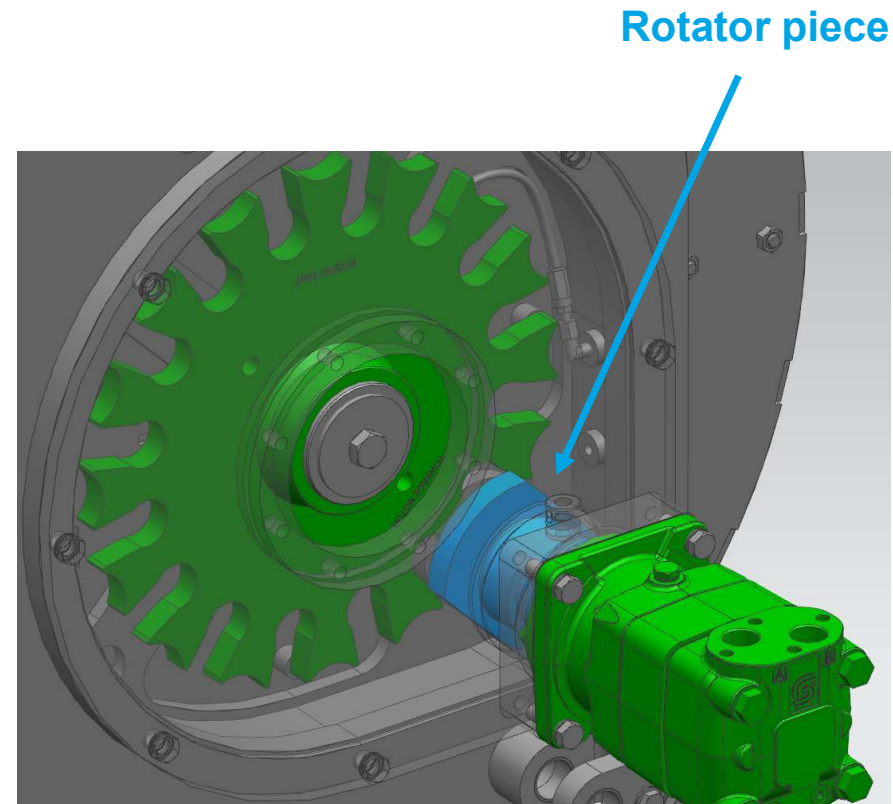
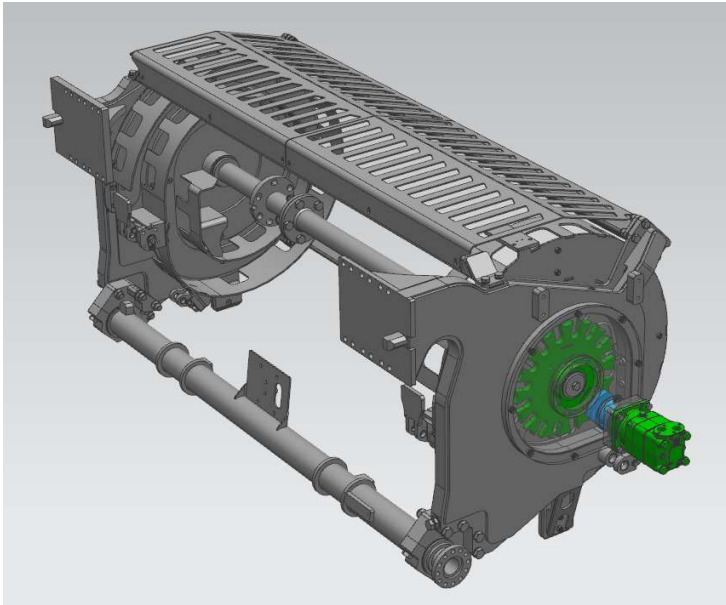

Background

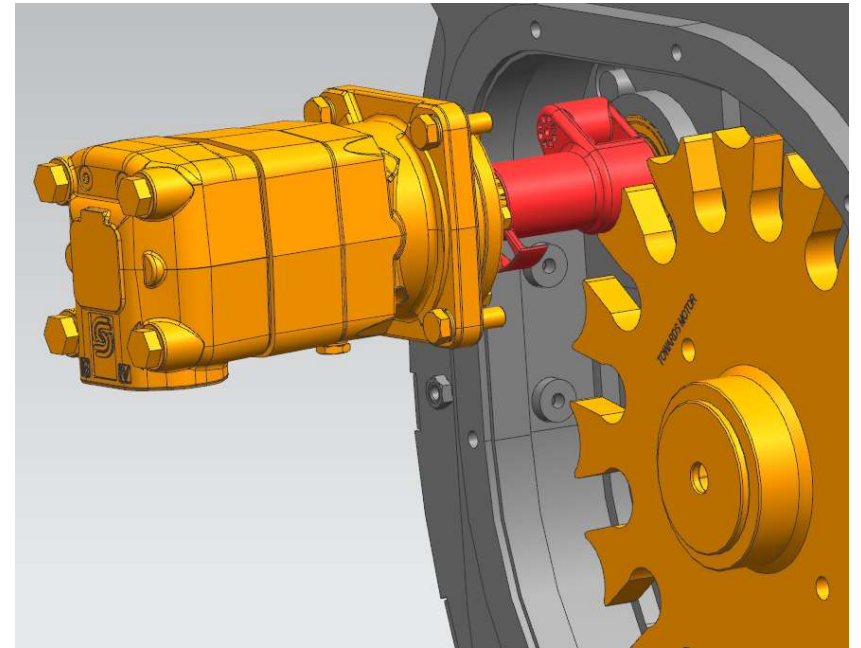
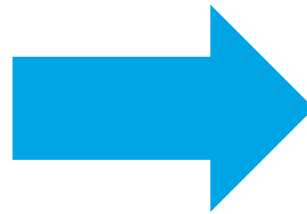
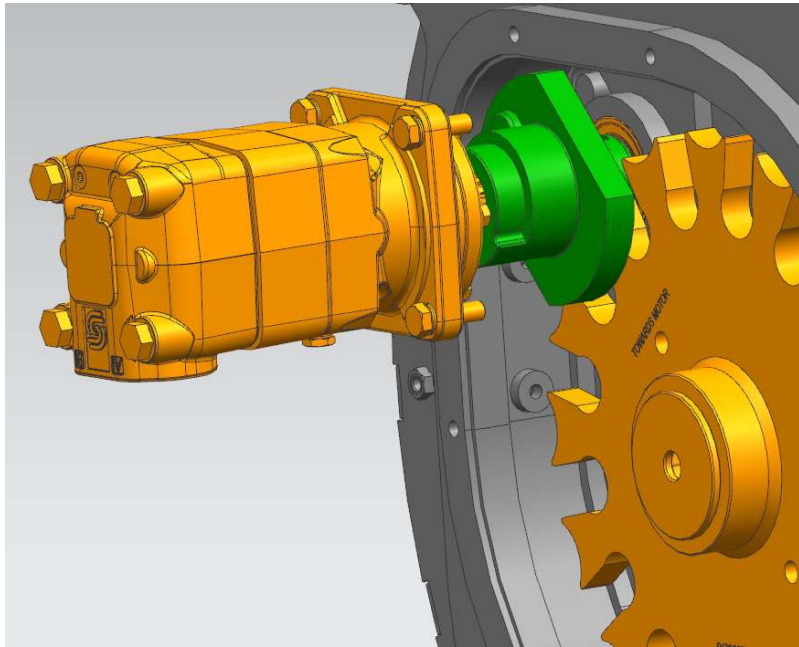

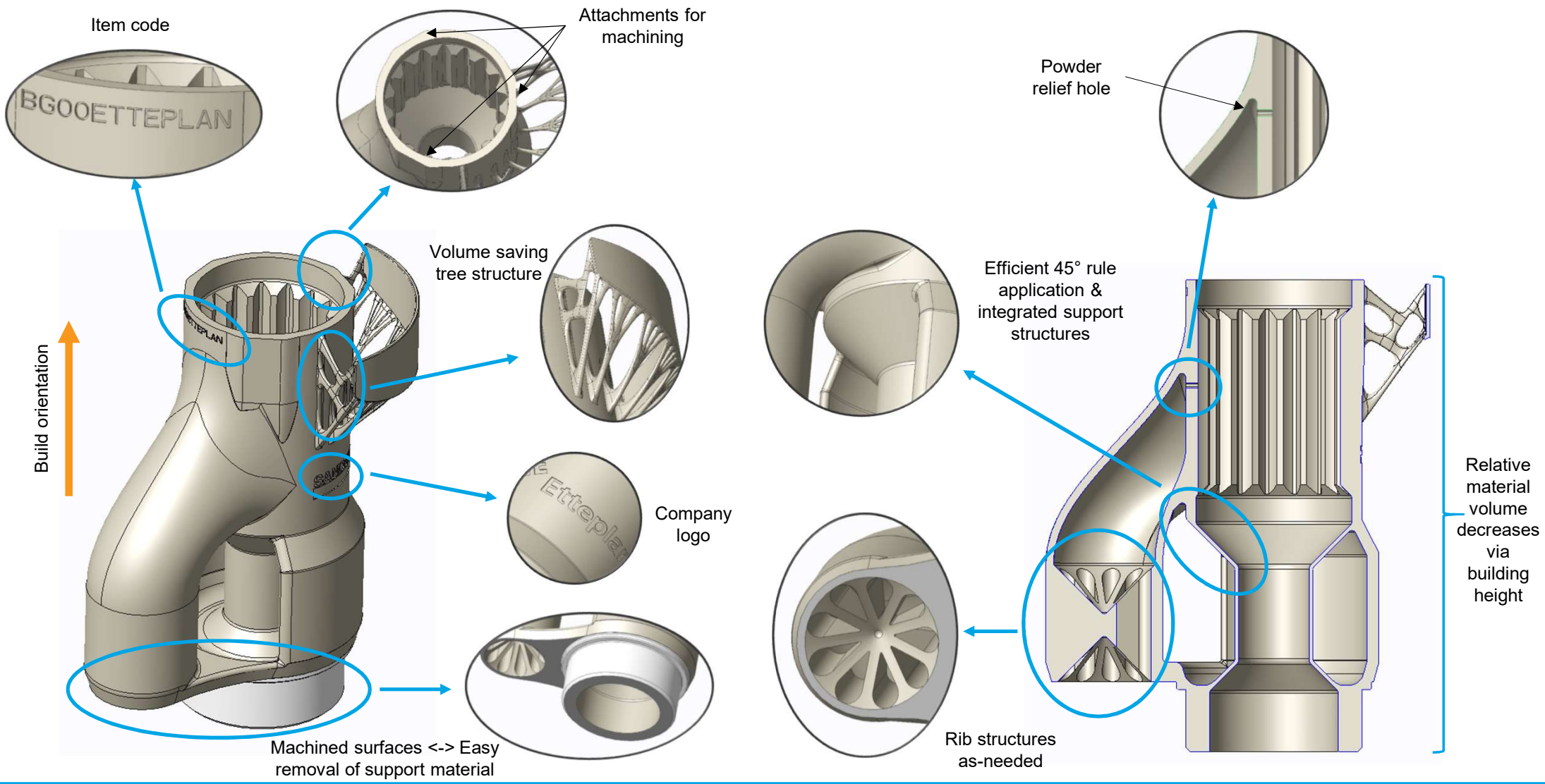

Final result

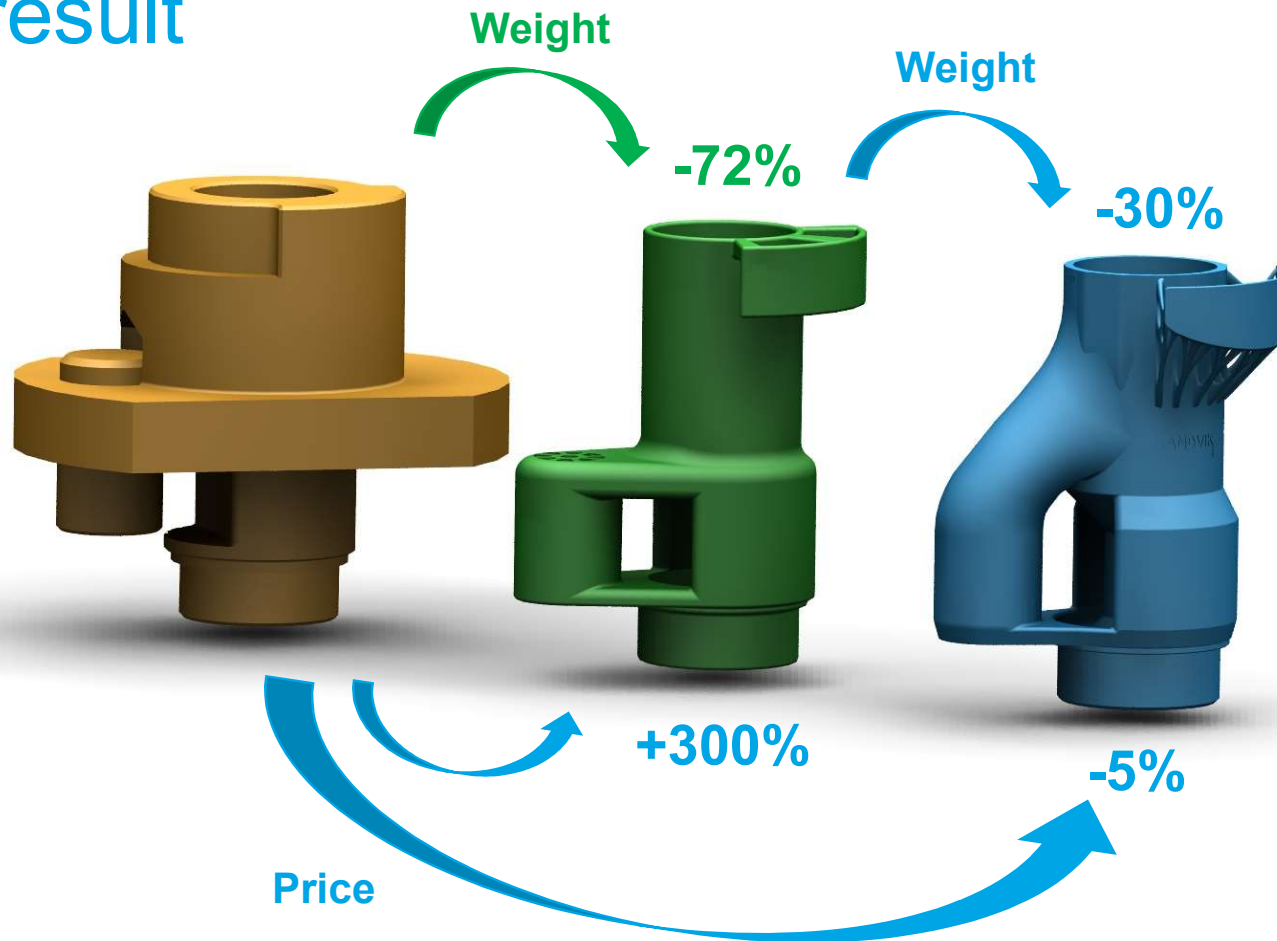



Contact details

Johannes Karjalainen

AM specialist

johannes.karjalainen@etteplan.com

Mobile: +358 40 549 0943