

MMT-DUNCHA

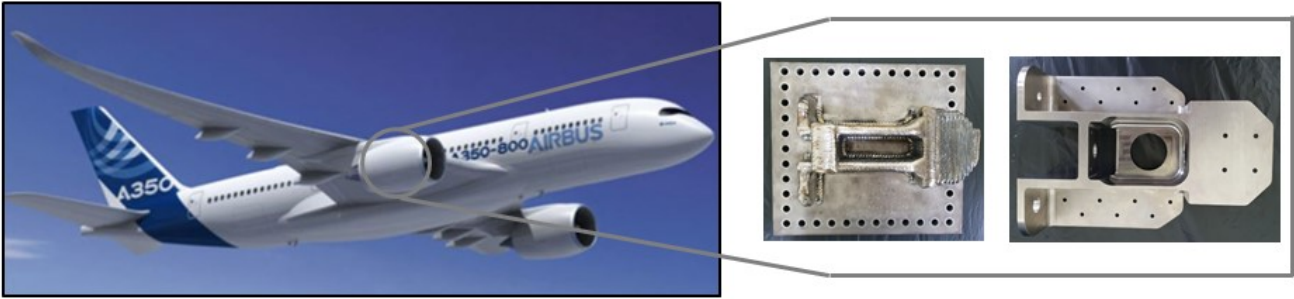

AIRCRAFT – NACELLE / LATCH HOUSING

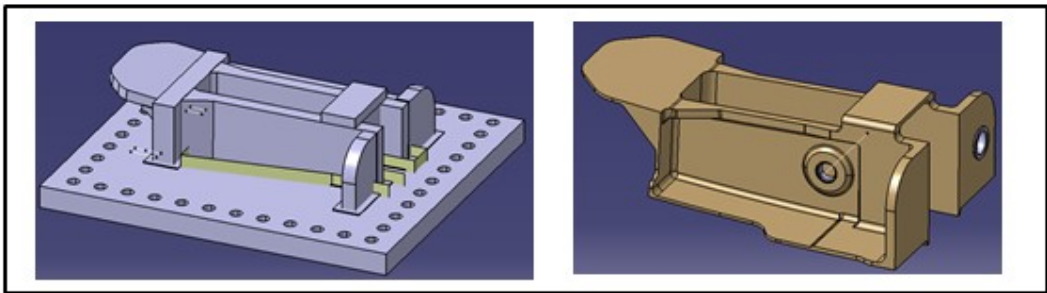

INFO

AIRBUS – A350 Model Application

- Nacelle System Components (Engine Structure)
- Component in Approval
- Customer: Collins Aerospace
- Class-1 Component: High Tensile Requirement

TECHNICAL DATA

Machine: 3D MP / arc405
 Material: Ti6Al4V / Wire
 Weight (Net): 1.10 Kg
 Welded Vol: 3.50 Kg

BENEFIT

- Material Saving
 “Conventional-25 Kg vs “3D MP- 3.50 Kg”
- Machining Cycle Time Reduction
- Machining Tool Consumption Reduction
- Flexibility for Design Update

SUMMARY

-  Material Save
-  Cost Save
-  Quick Lead Time

ASIA / MMT-DUNCHA CO., LTD.
 35, Hansan-Gil, Cheongbuk-Eup
 Pyeongtaek-Si, Gyonggi-Do, 17792 S. Korea
shryu@duncha.co.kr

EUROPE / DUNCHA FRANCE S.A.S
 22 Boulevard de l'Industrie
 41000 Blois, France
a.minkenberg@duncha.fr